



LATTC

All Campus Meeting

DECEMBER 13, 2024

Agenda

- ▶ Welcome!
- ▶ BUILD-LACCD Updates
- ▶ Office of the President Update
- ▶ Administrative Services Update
- ▶ Academic Affairs Update
- ▶ Student Services Update

Purpose of All Campus Meeting

- ▶ Create a space where the executive team can respond to current college questions submitted in advance, provide some high-level updates, and provide visionary leadership.
- ▶ Not a townhall. More of a townhall dialogue takes place during the president listening sessions and data dialogue days.
- ▶ Questions due Friday BEFORE the scheduled meeting.
PresidentsOffice@lattc.edu

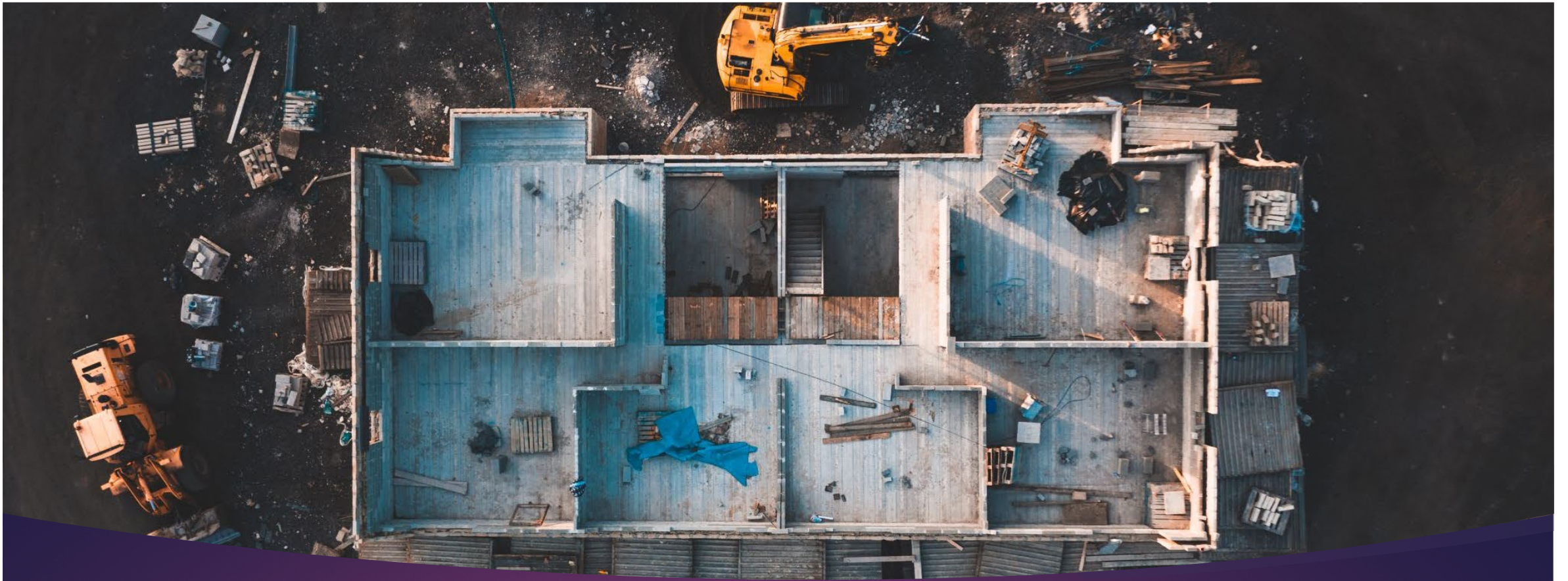

BUILD-LACCD Updates for Fall 2024

Trade Tech Projects Presentation



- ▶ Construction Technology Building (E6)
- ▶ Culinary Arts Building (E3)
- ▶ Campus Electrical Upgrade/Energy Management System
- ▶ Storm Water – North Quad
- ▶ Miscellaneous Improvements in C4, D3, D4 and B1
- ▶ Theater Demo
- ▶ Door Lock Replacement
- ▶ Design and Media Arts Building
- ▶ ADA Tai Improvements (Elevator/Paths of Travel/Signage)
- ▶ Mariposa Hall PV (Completion)
- ▶ Elevator Repair
- ▶ Measure LA
- ▶ South Field Next Phase

CPT PD: Scott Preston (Interim)
Program MP: Deborah Wylie

12/13/2024

Construction Technology Building (CTB)

- Construction started Q1 2020 and stopped in 2023 due to lack of approved CCDs
- Contract has been established with new DBE and Design NTP issued 8/12/2024
- GC to submit Final Lump Sum Cost to District by late Dec. 2024 for approval in Jan. or Feb. 2025 Board meeting
- Construction NTP is on track to be issued in March 2025
- Interim Temp GC to continue work until Construction NTP issued to DBE

- ▶ **Construction Technology Building (E6)**
- ▶ Culinary Arts Building (E3)
- ▶ Campus Electrical Upgrade/Energy Management System
- ▶ Storm Water – North Quad
- ▶ Miscellaneous Improvements in C4, D3, D4 and B1
- ▶ Theater Demo
- ▶ Door Lock Replacement
- ▶ Design and Media Arts Building
- ▶ ADA Tai Improvements (Elevator/Paths of Travel/Signage)
- ▶ Mariposa Hall PV (Completion)
- ▶ Elevator Repair
- ▶ Measure LA
- ▶ South Field Next Phase

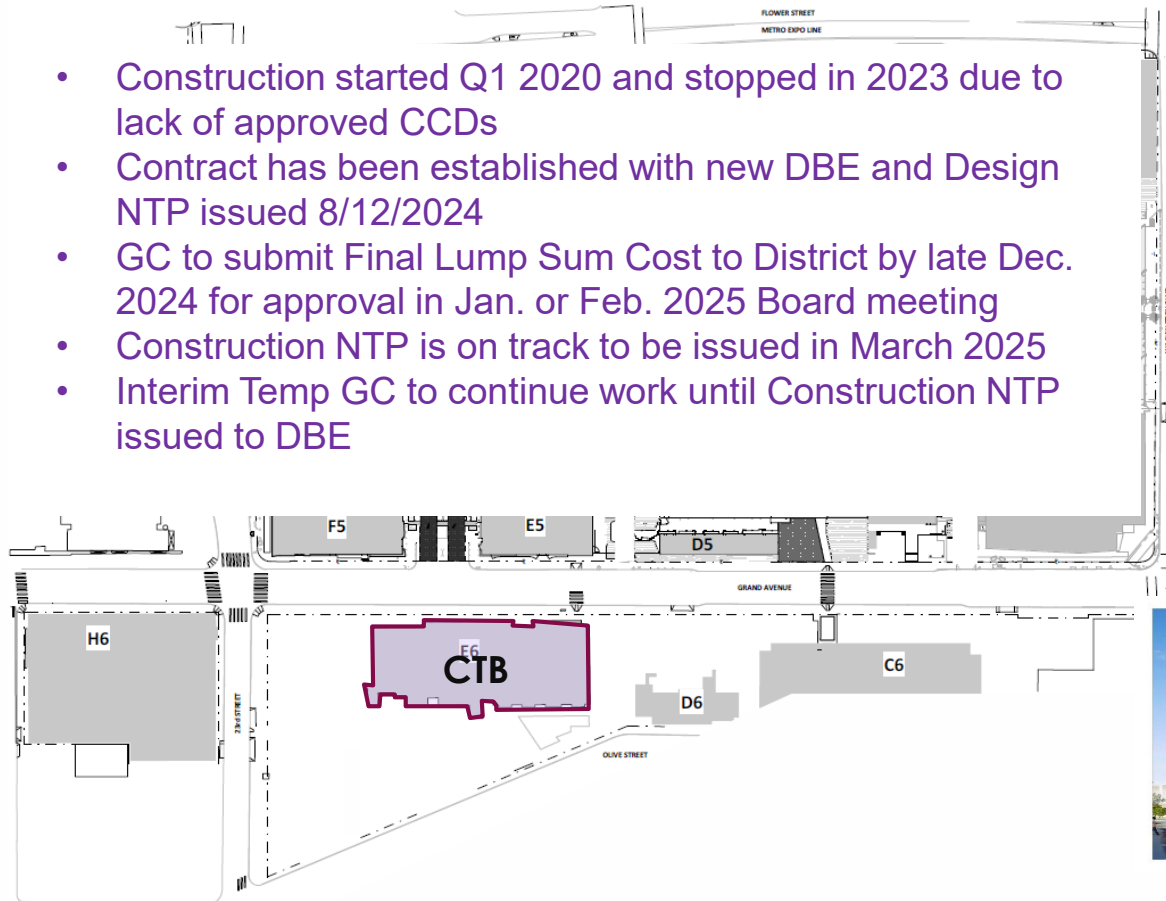

Culinary Arts Building (E3)

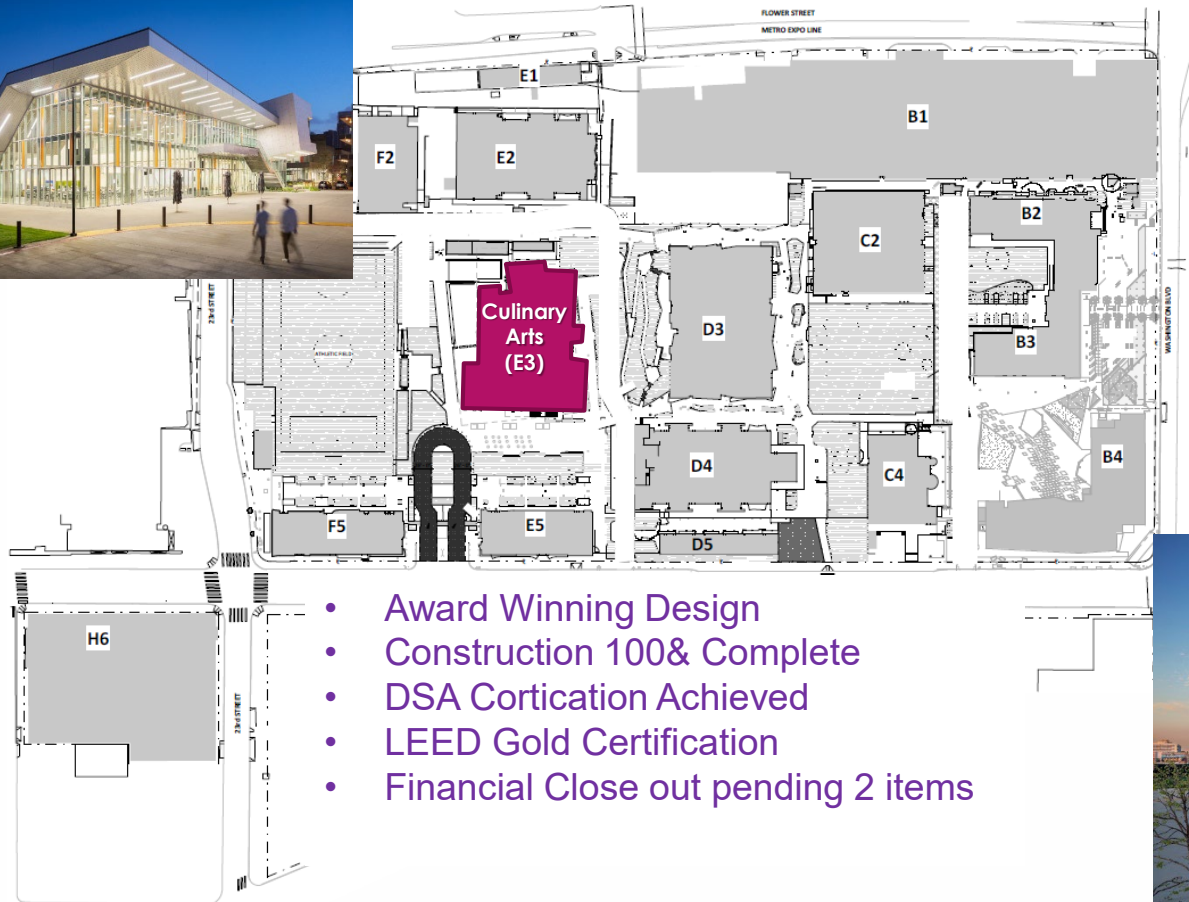

- ▶ Construction Technology Building (E6)
- ▶ **Culinary Arts Building (E3)**
- ▶ Campus Electrical Upgrade/Energy Management System
- ▶ Storm Water – North Quad
- ▶ Miscellaneous Improvements in C4, D3, D4 and B1
- ▶ Theater Demo
- ▶ Door Lock Replacement
- ▶ Design and Media Arts Building
- ▶ ADA Tai Improvements (Elevator/Paths of Travel/Signage)
- ▶ Mariposa Hall PV (Completion)
- ▶ Elevator Repair
- ▶ Measure LA
- ▶ South Field Next Phase

- Award Winning Design
- Construction 100% Complete
- DSA Cortication Achieved
- LEED Gold Certification
- Financial Close out pending 2 items



Campus Electrical Upgrade Energy Management System (EMS)



- ▶ Construction Technology Building (E6)
- ▶ Culinary Arts Building (E3)
- ▶ **Campus Electrical Upgrade/Energy Management System**
- ▶ Storm Water – North Quad
- ▶ Miscellaneous Improvements in C4, D3, D4 and B1
- ▶ Theater Demo
- ▶ Door Lock Replacement
- ▶ Design and Media Arts Building
- ▶ ADA Tai Improvements (Elevator/Paths of Travel/Signage)
- ▶ Mariposa Hall PV (Completion)
- ▶ Elevator Repair
- ▶ Measure LA
- ▶ South Field Next Phase

Electrical Upgrade:

- DSA Approved
- Addendum #2 Redesign in progress

EMS

- DSA approved and bid for GC
- Schedule TBD

Storm Water North Quad

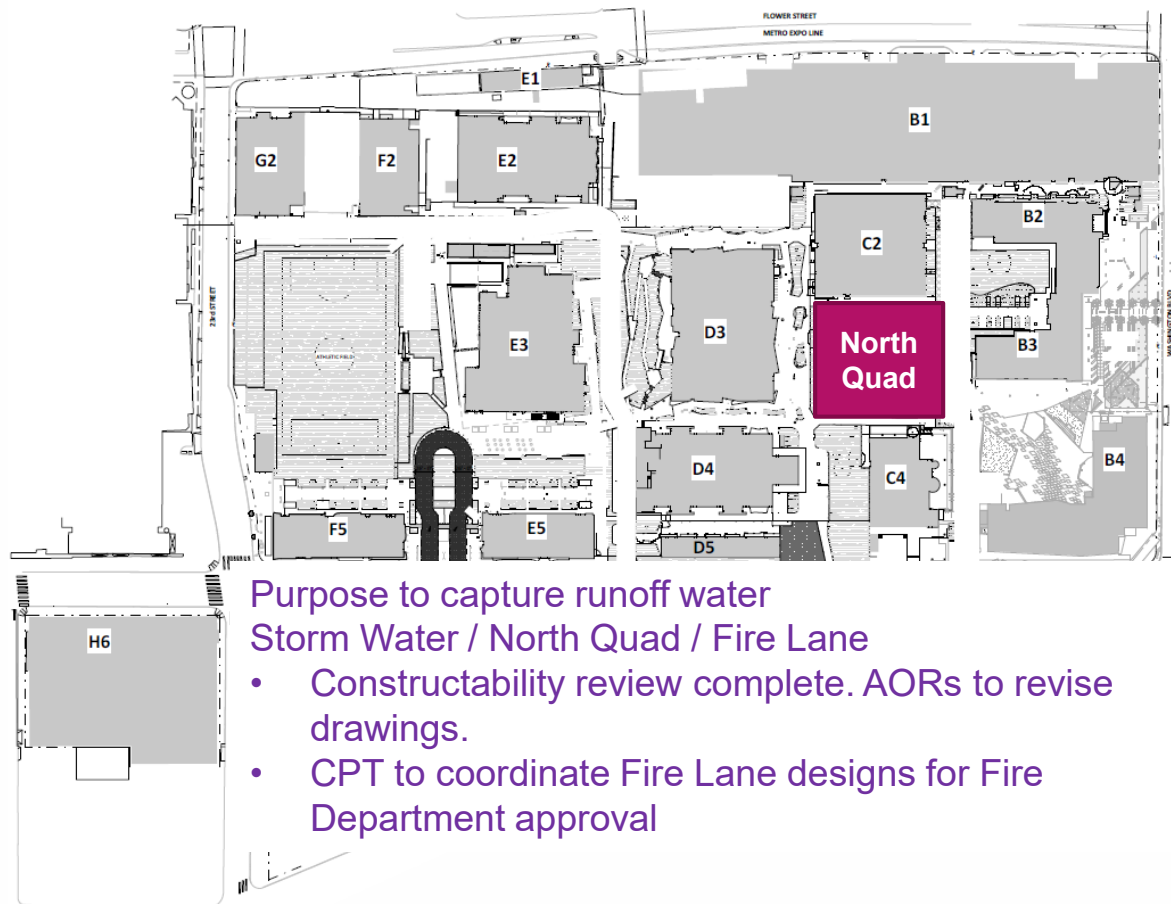

- ▶ Construction Technology Building (E6)
- ▶ Culinary Arts Building (E3)
- ▶ Campus Electrical Upgrade/Energy Management System
- ▶ **Storm Water – North Quad**
- ▶ Miscellaneous Improvements in C4, D3, B1 – (On Hold)
- ▶ Theater Demo
- ▶ Door Lock Replacement
- ▶ Design and Media Arts Building
- ▶ ADA Tai Improvements (Elevator/Paths of Travel/Signage)
- ▶ Mariposa Hall PV (Completion)
- ▶ Elevator Repair
- ▶ Measure LA
- ▶ South Field Next Phase



Miscellaneous Improvements C4, D3, D4 and B1

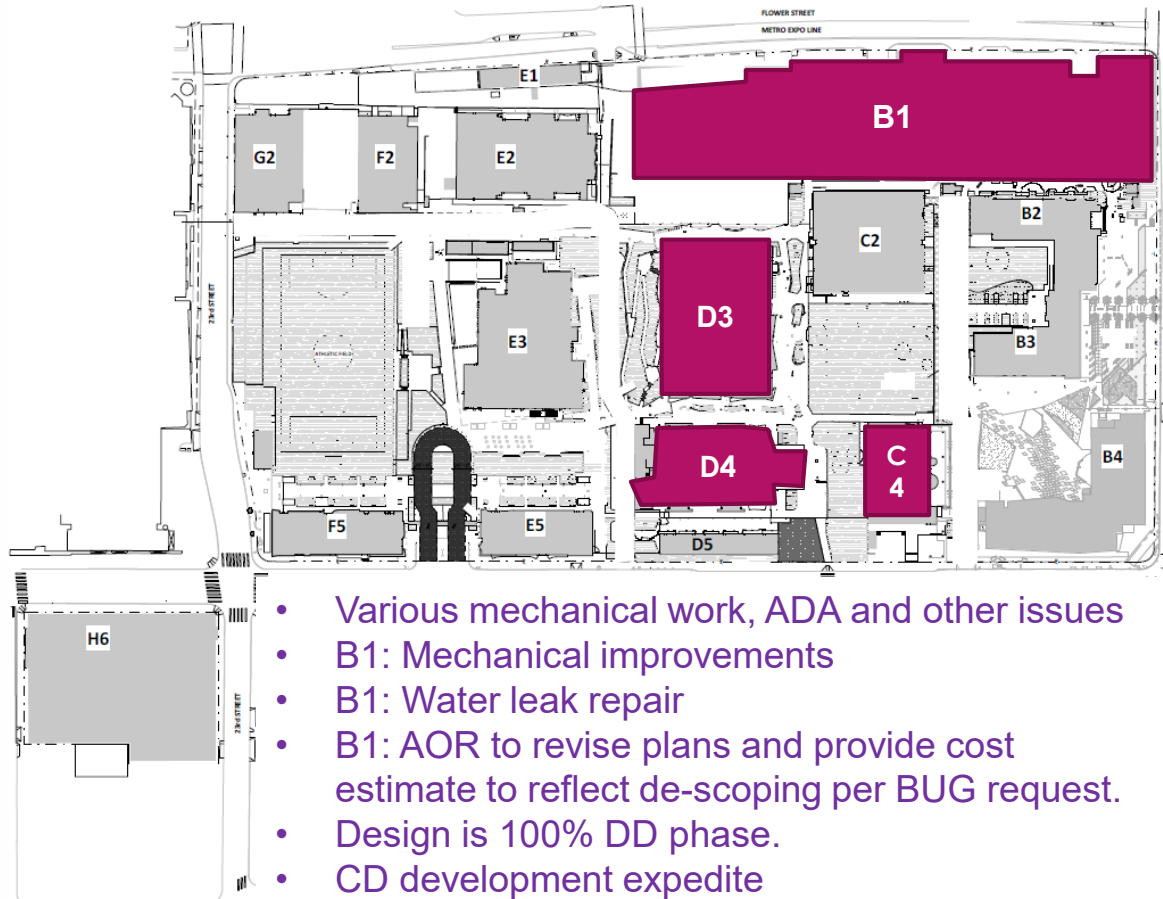

- ▶ Construction Technology Building (E6)
- ▶ Culinary Arts Building (E3)
- ▶ Campus Electrical Upgrade/Energy Management System
- ▶ Storm Water – North Quad
- ▶ Miscellaneous Improvements in C4 (On Hold), D3;- D4 (Has Been Canceled) B1 (On Hold)
- ▶ Theater Demo
- ▶ Door Lock Replacement
- ▶ Design and Media Arts Building
- ▶ ADA Tai Improvements (Elevator/Paths of Travel/Signage)
- ▶ Mariposa Hall PV (Completion)
- ▶ Elevator Repair
- ▶ Measure LA
- ▶ South Field Next Phase

- Various mechanical work, ADA and other issues
- B1: Mechanical improvements
- B1: Water leak repair
- B1: AOR to revise plans and provide cost estimate to reflect de-scoping per BUG request.
- Design is 100% DD phase.
- CD development expedite



Door Lock Replacement

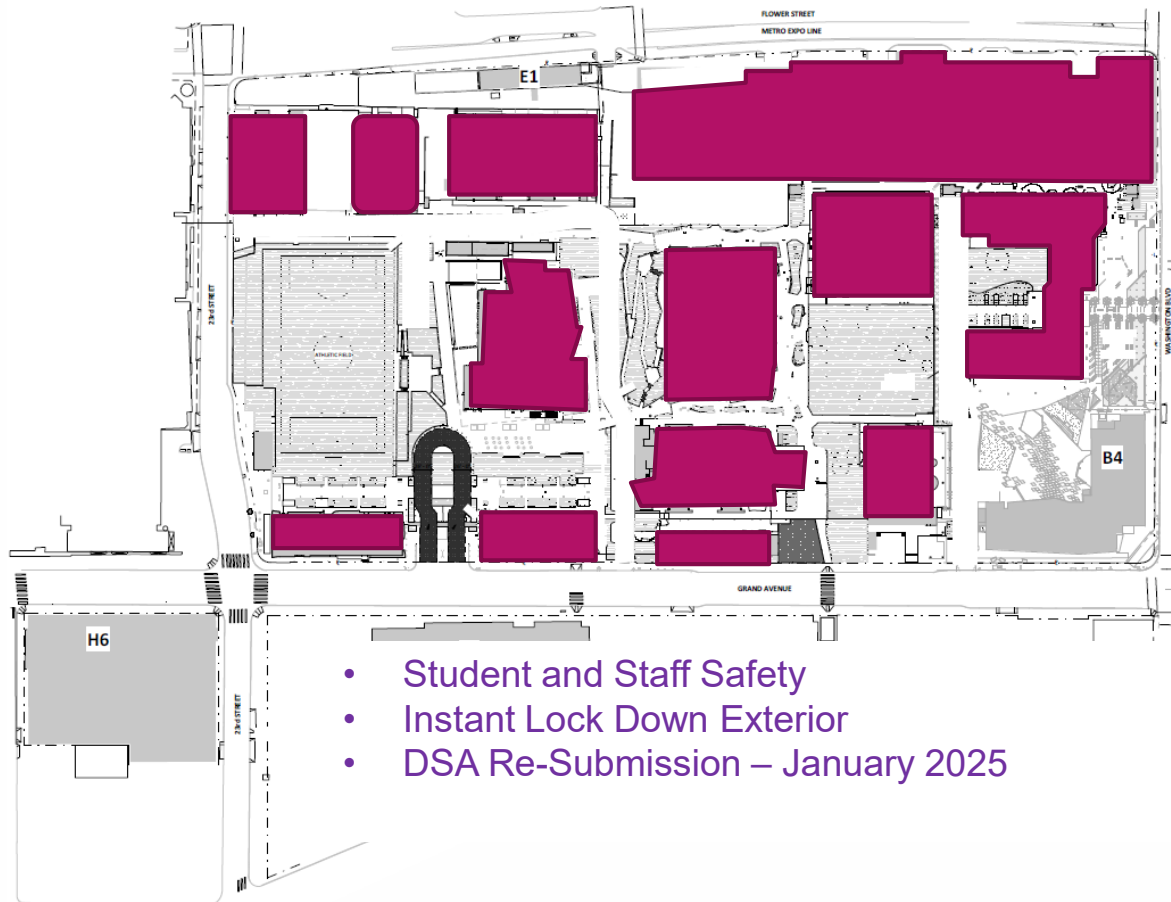

- ▶ Construction Technology Building (E6)
- ▶ Culinary Arts Building (E3)
- ▶ Campus Electrical Upgrade/Energy Management System
- ▶ Storm Water – North Quad
- ▶ Miscellaneous Improvements in C4, D3, D4 and B1
- ▶ Theater Demo
- ▶ **Door Lock Replacement**
- ▶ Design and Media Arts Building
- ▶ ADA Tai Improvements (Elevator/Paths of Travel/Signage)
- ▶ Mariposa Hall PV (Completion)
- ▶ Elevator Repair
- ▶ Measure LA
- ▶ South Field Next Phase

- Student and Staff Safety
- Instant Lock Down Exterior
- DSA Re-Submission – January 2025

Theater Demolition

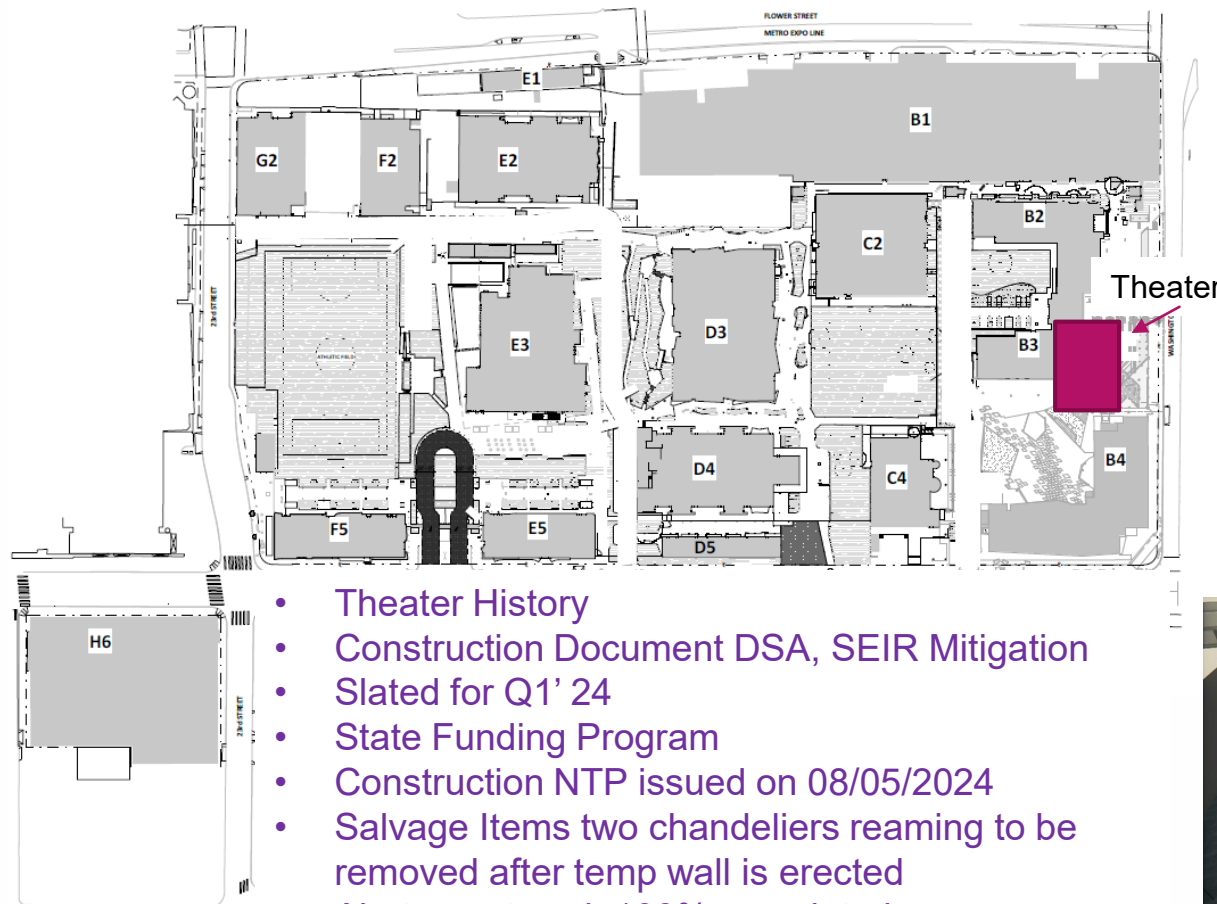

- ▶ Construction Technology Building (E6)
- ▶ Culinary Arts Building (E3)
- ▶ Campus Electrical Upgrade/Energy Management System
- ▶ Storm Water – North Quad
- ▶ Miscellaneous Improvements in C4, D3, D4 and B1
- ▶ **Theater Demo**
- ▶ Door Lock Replacement
- ▶ Design and Media Arts Building
- ▶ ADA Tai Improvements (Elevator/Paths of Travel/Signage)
- ▶ Mariposa Hall PV (Completion)
- ▶ Elevator Repair
- ▶ Measure LA
- ▶ South Field Next Phase

- Theater History
- Construction Document DSA, SEIR Mitigation
- Slated for Q1' 24
- State Funding Program
- Construction NTP issued on 08/05/2024
- Salvage Items two chandeliers reaming to be removed after temp wall is erected
- Abatement work 100% completed



Design Media Arts (DMA)

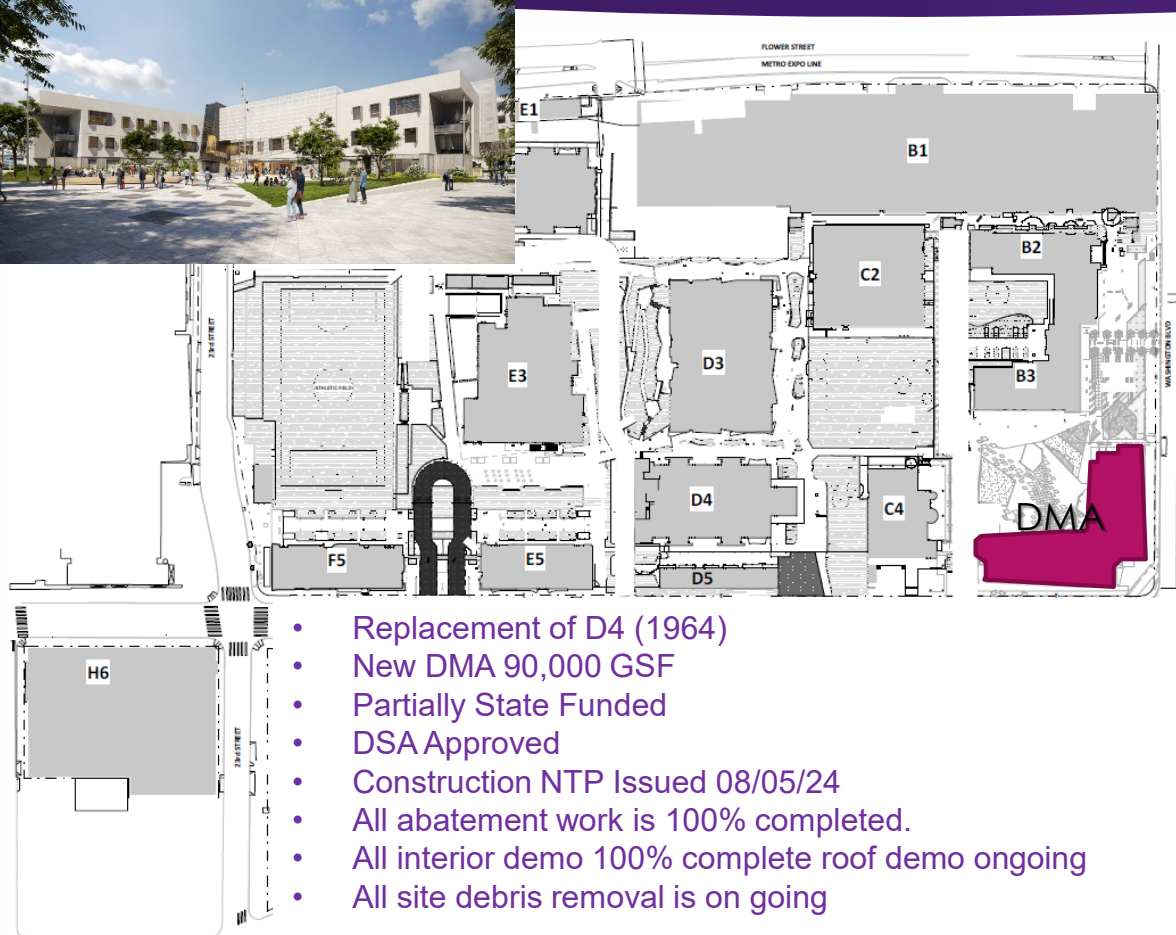

- ▶ Construction Technology Building (E6)
- ▶ Culinary Arts Building (E3)
- ▶ Campus Electrical Upgrade/Energy Management System
- ▶ Storm Water – North Quad
- ▶ Miscellaneous Improvements in C4, D3, D4 and B1
- ▶ Theater Demo
- ▶ Door Lock Replacement
- ▶ **Design and Media Arts Building**
- ▶ ADA Tai Improvements (Elevator/Paths of Travel/Signage)
- ▶ Mariposa Hall PV (Completion)
- ▶ Elevator Repair
- ▶ Measure LA
- ▶ South Field Next Phase

- Replacement of D4 (1964)
- New DMA 90,000 GSF
- Partially State Funded
- DSA Approved
- Construction NTP Issued 08/05/24
- All abatement work is 100% completed.
- All interior demo 100% complete roof demo ongoing
- All site debris removal is on going



ADA TAI Improvements (Elevator – Path of Travels – Signage)

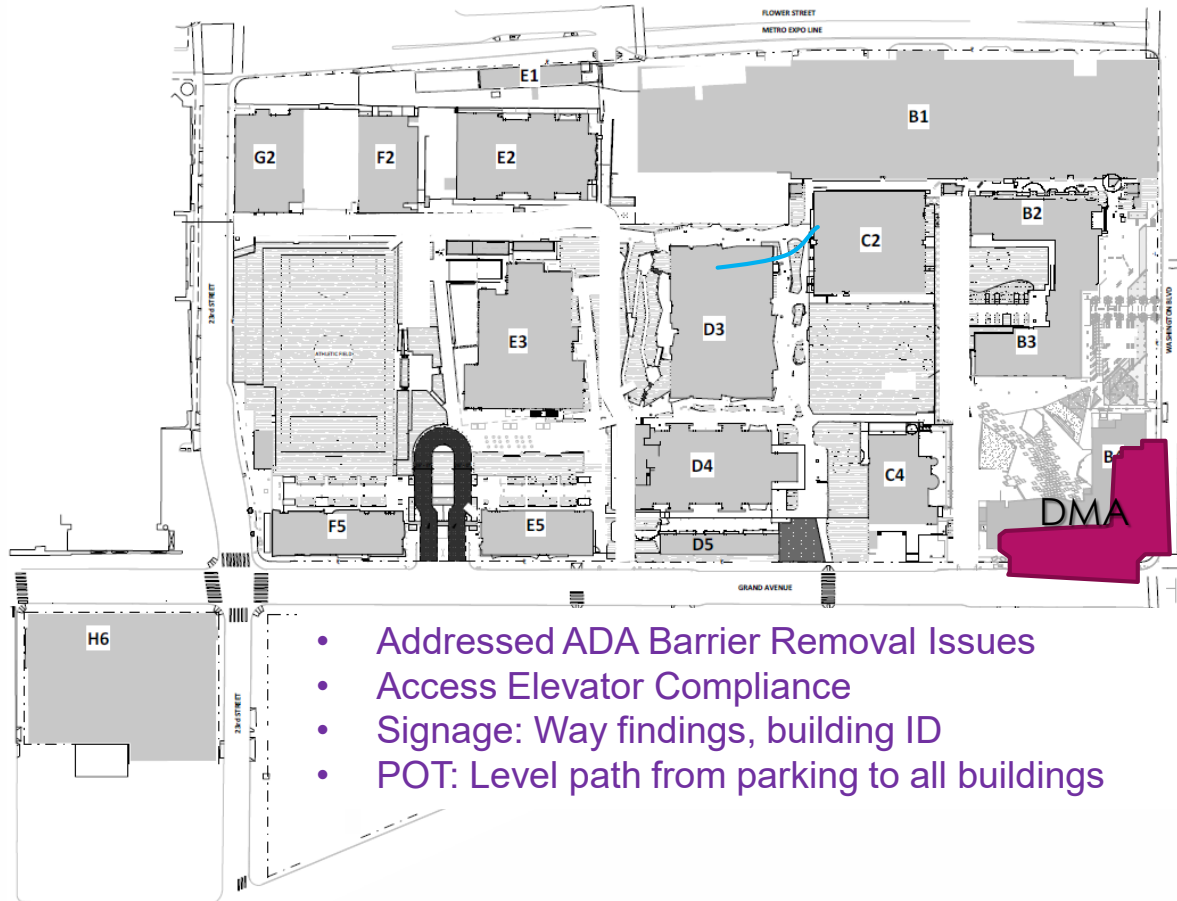

- Addressed ADA Barrier Removal Issues
- Access Elevator Compliance
- Signage: Way findings, building ID
- POT: Level path from parking to all buildings

- ▶ Construction Technology Building (E6)
- ▶ Culinary Arts Building (E3)
- ▶ Campus Electrical Upgrade/Energy Management System
- ▶ Storm Water – North Quad
- ▶ Miscellaneous Improvements in C4, D3, D4 and B1
- ▶ Theater Demo
- ▶ Door Lock Replacement
- ▶ Design and Media Arts Building
- ▶ **ADA TAI Improvements (Elevator/Paths of Travel/Signage)**
- ▶ Mariposa Hall PV (Completion)
- ▶ Elevator Repair
- ▶ Measure LA
- ▶ South Field Next Phase



Mariposa Hall PV

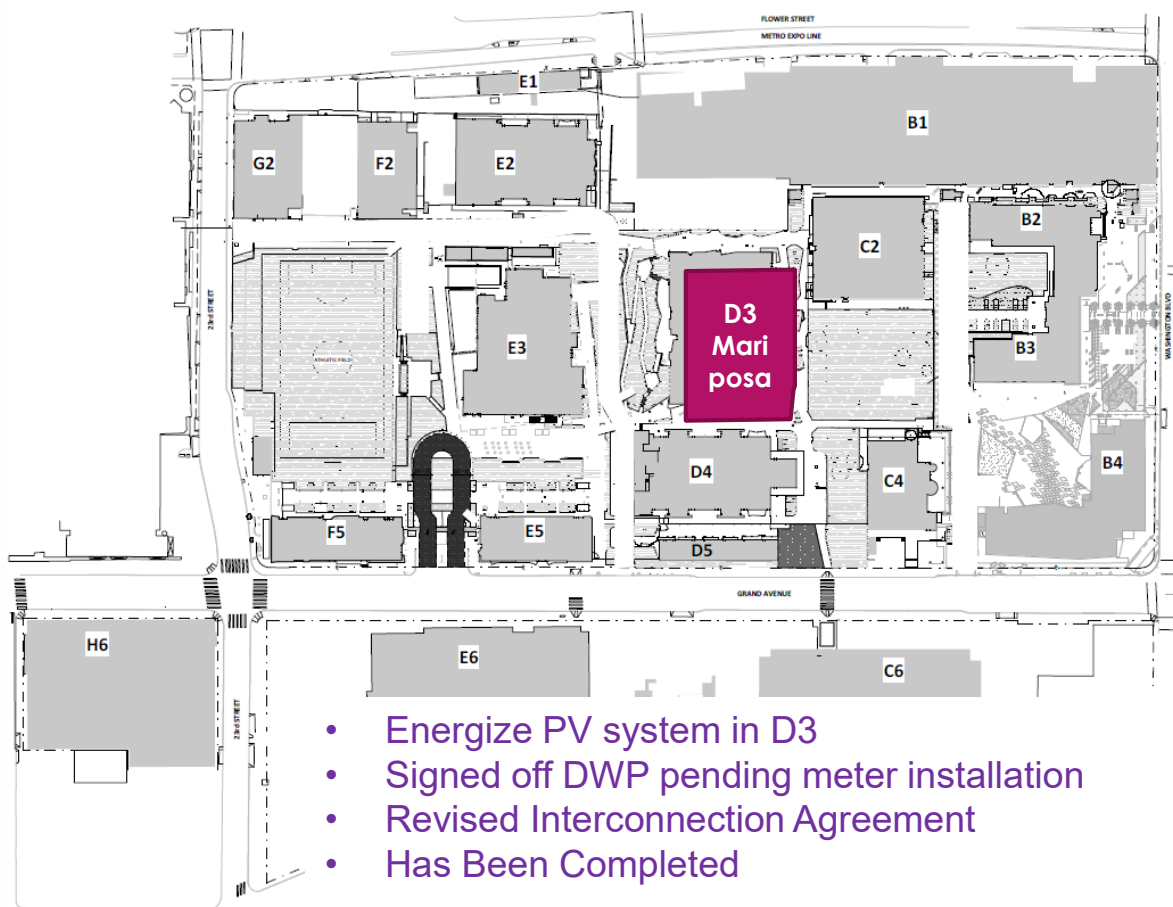

- Energize PV system in D3
- Signed off DWP pending meter installation
- Revised Interconnection Agreement
- Has Been Completed

- ▶ Construction Technology Building (E6)
- ▶ Culinary Arts Building (E3)
- ▶ Campus Electrical Upgrade/Energy Management System
- ▶ Storm Water – North Quad
- ▶ Miscellaneous Improvements in C4, D3, D4 and B1
- ▶ Theater Demo
- ▶ Door Lock Replacement
- ▶ Design and Media Arts Building
- ▶ ADA Tai Improvements (Elevator/Paths of Travel/Signage)
- ▶ **Mariposa Hall PV (Completion)**
- ▶ Elevator Repair
- ▶ Measure LA
- ▶ South Field Next Phase



Elevator Repair

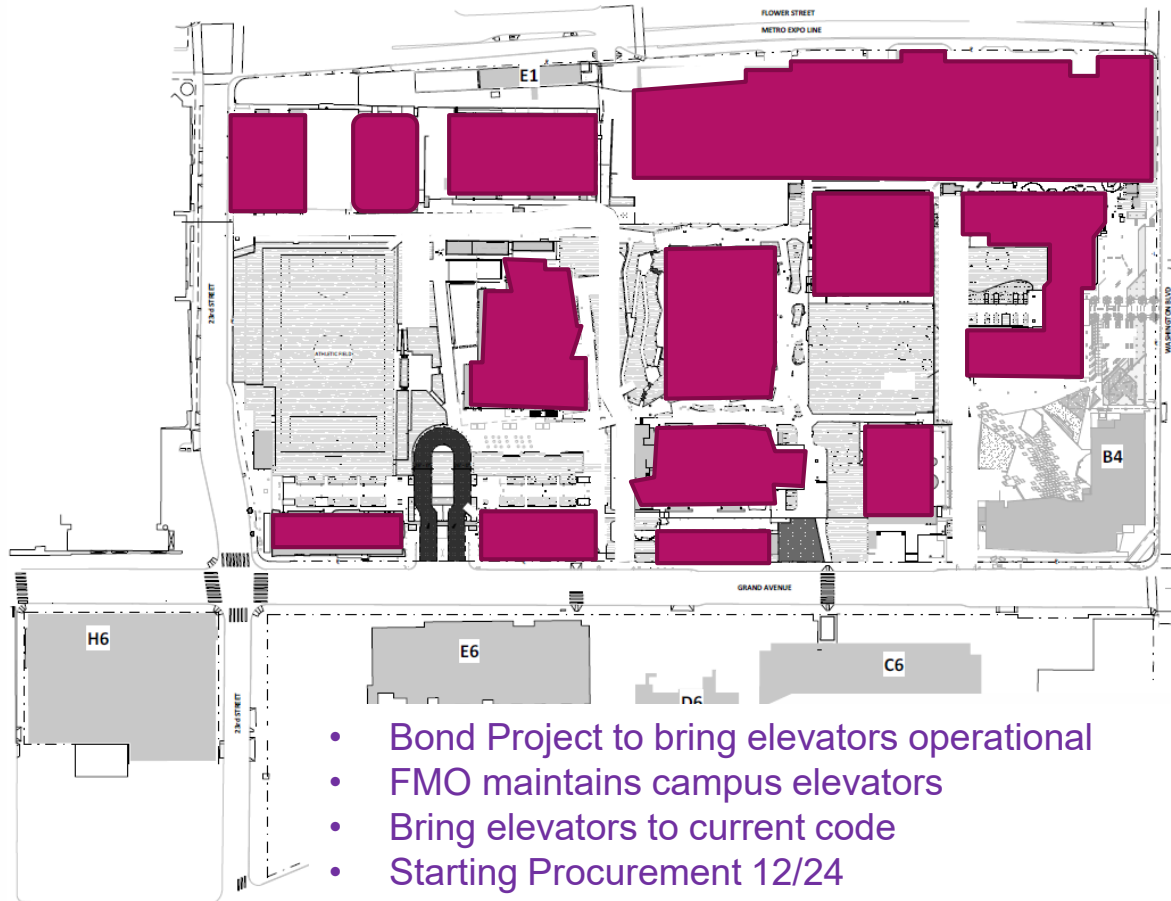

- ▶ Construction Technology Building (E6)
- ▶ Culinary Arts Building (E3)
- ▶ Campus Electrical Upgrade/Energy Management System
- ▶ Storm Water – North Quad
- ▶ Miscellaneous Improvements in C4, D3, D4 and B1
- ▶ Theater Demo
- ▶ Door Lock Replacement
- ▶ Design and Media Arts Building
- ▶ ADA Tai Improvements (Elevator/Paths of Travel/Signage)
- ▶ Mariposa Hall PV (Completion)
- ▶ **Elevator Repair**
- ▶ Measure LA
- ▶ South Field Next Phase

- Bond Project to bring elevators operational
- FMO maintains campus elevators
- Bring elevators to current code
- Starting Procurement 12/24



Measure LA



- ▶ Construction Technology Building (E6)
- ▶ Culinary Arts Building (E3)
- ▶ Campus Electrical Upgrade/Energy Management System
- ▶ Storm Water – North Quad
- ▶ Miscellaneous Improvements in C4, D3, D4 and B1
- ▶ Theater Demo
- ▶ Door Lock Replacement
- ▶ Design and Media Arts Building
- ▶ ADA Tai Improvements (Elevator/Paths of Travel/Signage)
- ▶ Mariposa Hall PV (Completion)
- ▶ Elevator Repair
- ▶ **Measure LA**
- ▶ South Field Next Phase

- Athletic Fields Scope
- LED Upgrade (Phase 2 Interior Lighting): Campus Wide
- Switchgear Replacement at Building B1
- Fencing
- Sewer Line Replacement
- Infrastructure – Campus Wide Electrical Distribution Assessment and Repairs
- Campus wide EMS (BMS) system



South Field (Next Phase)

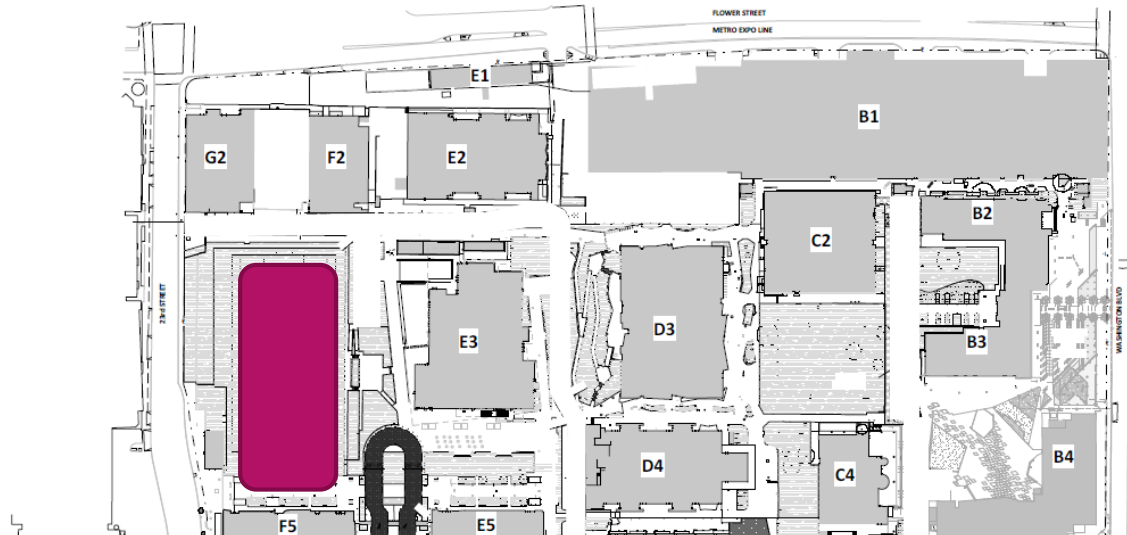

- ▶ Construction Technology Building (E6)
- ▶ Culinary Arts Building (E3)
- ▶ Campus Electrical Upgrade/Energy Management System
- ▶ Storm Water – North Quad
- ▶ Miscellaneous Improvements in C4, D3, D4 and B1
- ▶ Theater Demo
- ▶ Door Lock Replacement
- ▶ Design and Media Arts Building
- ▶ ADA Tai Improvements (Elevator/Paths of Travel/Signage)
- ▶ Mariposa Hall PV (Completion)
- ▶ Elevator Repair
- ▶ Measure LA
- ▶ South Field Next Phase

- Remaining funds from the construction of the Culinary Arts Building and Measure LA funding are earmarked for improvements at the South Field.
- Including new bleachers for +/- 500, restrooms, field storage, fencing and field lighting.
- The desired scope exceeds the Culinary Arts budget allotment.
- CEQA review is anticipated.
- CPT is preparing a white paper for approval.



Master Plan / Next Steps

PLANNING ASSUMPTIONS

Demolitions

Committed Demolition / Inactivation

- E2 Construction, Maintenance and Utilities (CMU)
- D4 Design & Media Arts (DMA)
- D5 Facilities Maintenance & Operation (FMO)
- B1 Advanced Transportation & Manufacturing (ATM)

Proposed Demolition

- G2 Gymnasium & F2 Athletics (PE)

LEGEND

- Demolition
- YEAR Projected Demolition Year

Steinberg Hart

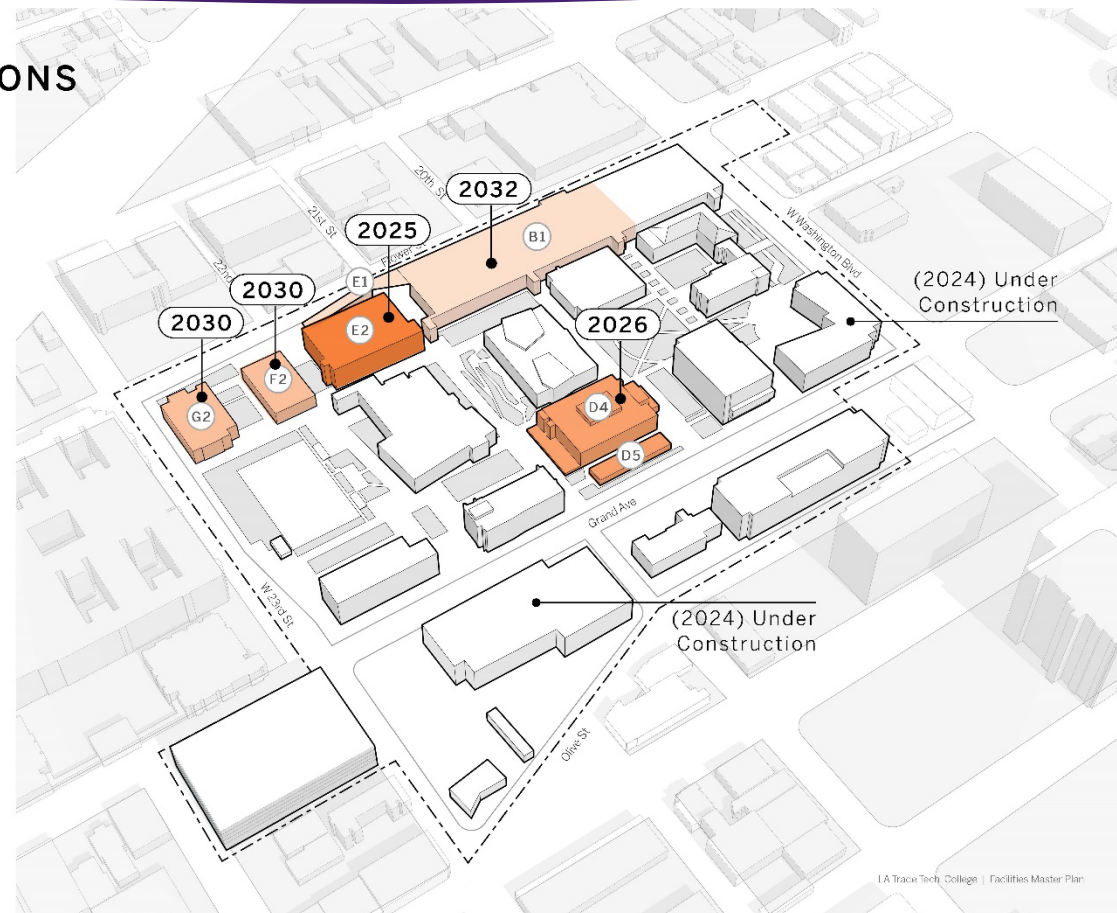

LA Trade Tech College | Facilities Master Plan

Master Plan / Next Steps

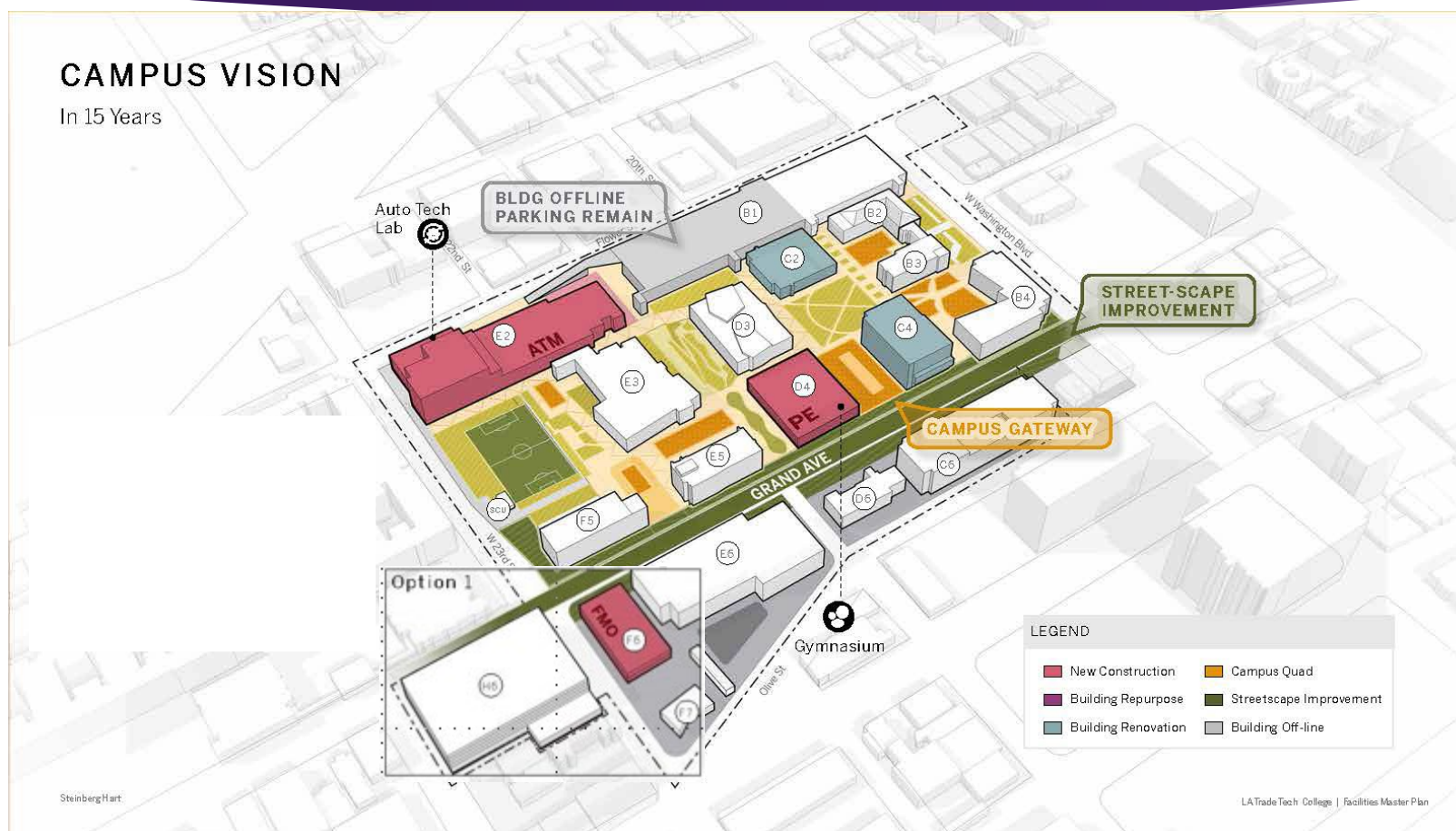



Office of President Update



100th Anniversary Merchandise

Items include apparel (varsity jacket, hoodies, t-shirts, polos), mugs, tumblers, lapel pins, notebooks, folders, pens.

Available in-store and online at the College Store.



100th Anniversary Webpage

Coming soon

Features 100th Anniversary events and alumni connection section

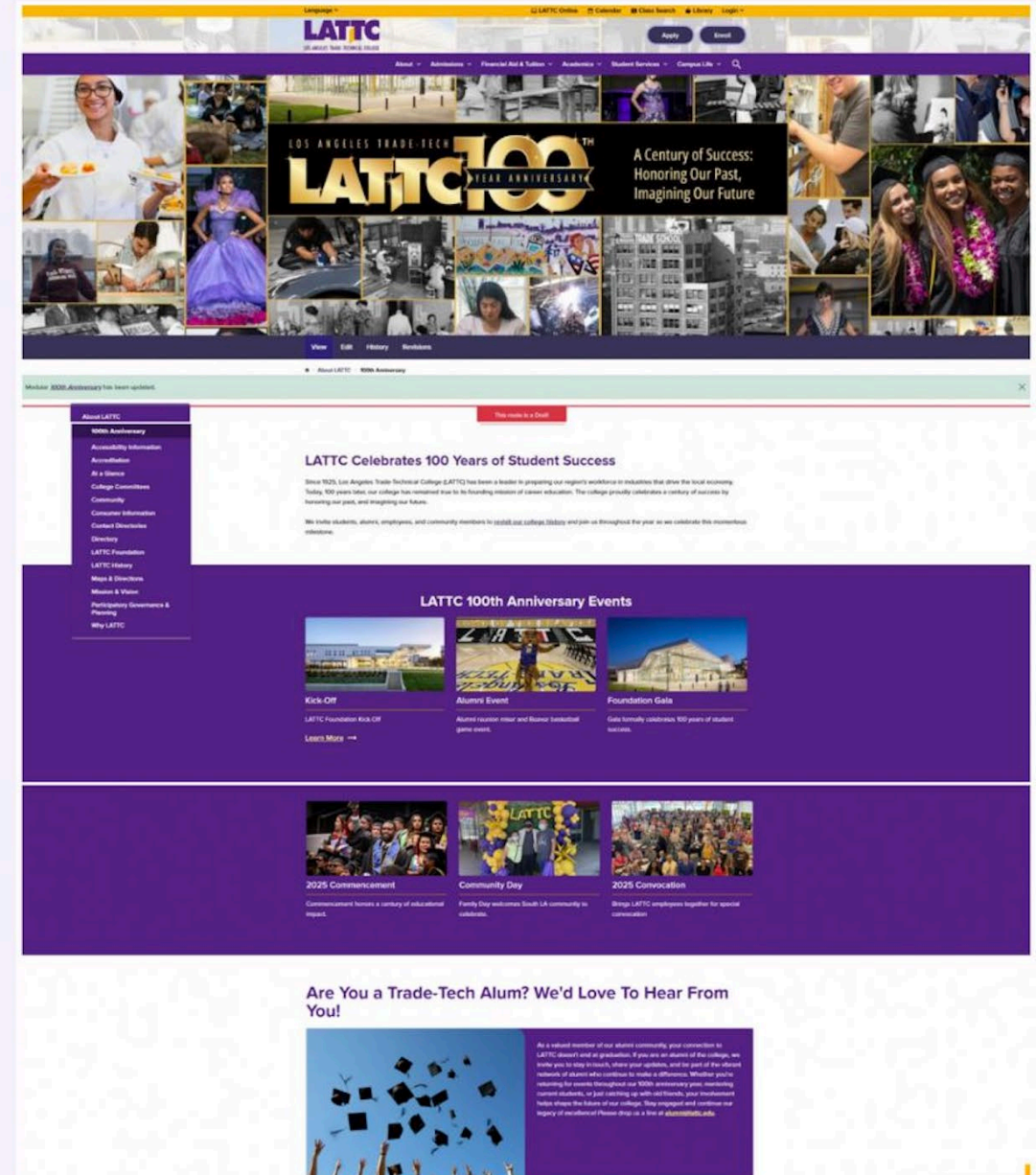



LATTC Centennial

Signature Events

The Los Angeles Trade-Technical College (LATTC) Foundation's 2025 Centennial Campaign: "**100 Years of Student Success and Pathways**" officially kicks off on December 4th, 2024, to encourage year-end support in advance of 2025 celebrations. Throughout 2025, the LATTC Foundation will bring together **sponsors, trade unions, alumni, City and District stakeholders, corporate and private supporters** to honor and celebrate the past 100 years while investing in the next 100 years of student success and pathways. **Together with the Foundation for the Los Angeles Community Colleges District (LACCD), the LATTC Foundation has already secured over \$192,500 in matching funds to support student scholarships throughout 2025.**

Please double your impact for our students by making a donation in 2024 and 2025!
<https://lattcfoundation.nationbuilder.com/lattcfoundation100>



Alumni Reunion Mixer & Beavers Basketball Game

Leads: Dr. Alfred McQuarters & Erin Yokomizo

The reunion event will gather **LATTC alumni** to celebrate the college's legacy. The aim is to highlight alumni success stories and strengthen connections with former students. Aided by alumni in the planning, this event will also enhance public relations efforts and reinforce alumni ties to the college and its ongoing mission.



LATTC Foundation Gala / Centennial Celebraiton

Leads: LATTC Foundation Co-Chairs Victor Reyes & Bonnie Tseng

The Gala celebrates 100 years of LATTC student success and our impactful career pathways. The goal is to bring together **corporate and industry sponsors & City stakeholders** to make meaningful connections that lead to more visibility and support for our students for the next 100 years. The event will be planned with input from the LATTC 100th Year Anniversary Committee, sponsors, and LATTC Foundation Board Members.

Alumni: Graduated in 1974



Andy Keseloff

- Project Engineer II & BUILD-LACCD
- Building Construction Technology (HVAC Sheet Metal program)
- Graduated the year the time capsule was placed

Alumni: Graduated in 1967

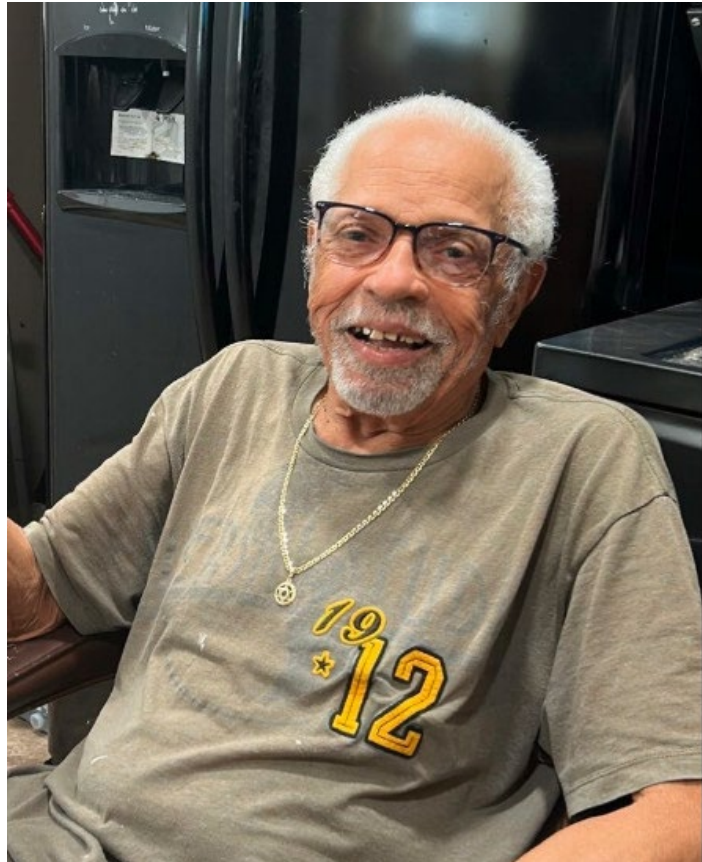

Joseph Hayward LaSalle

- Attended 1964-1967
- Welding graduate
- He played on the basketball team

North Star

- ▶ **Increase** in the categories which make up the **Student-Centered Funding Formula (SCFF)** each year by Fall 2030
- ▶ **Increase enrollment** within Pathways with capacity
- ▶ **Eliminate** all **retention** and completion disparities related to ethnicity, gender identity, College Promise recipient status, Pell Grant recipient status by Fall 2030
- ▶ **Increase** revenue and decrease expenses

Safe-Guarding Campus

- ▶ Coordination between the College, BUILD-LACCD, Contractor Site Security Company, & Sheriff's Office
- ▶ Motion sensors with horn alarms added
- ▶ Three security guards for the construction site
- ▶ Sheriff patrols (2 hours)

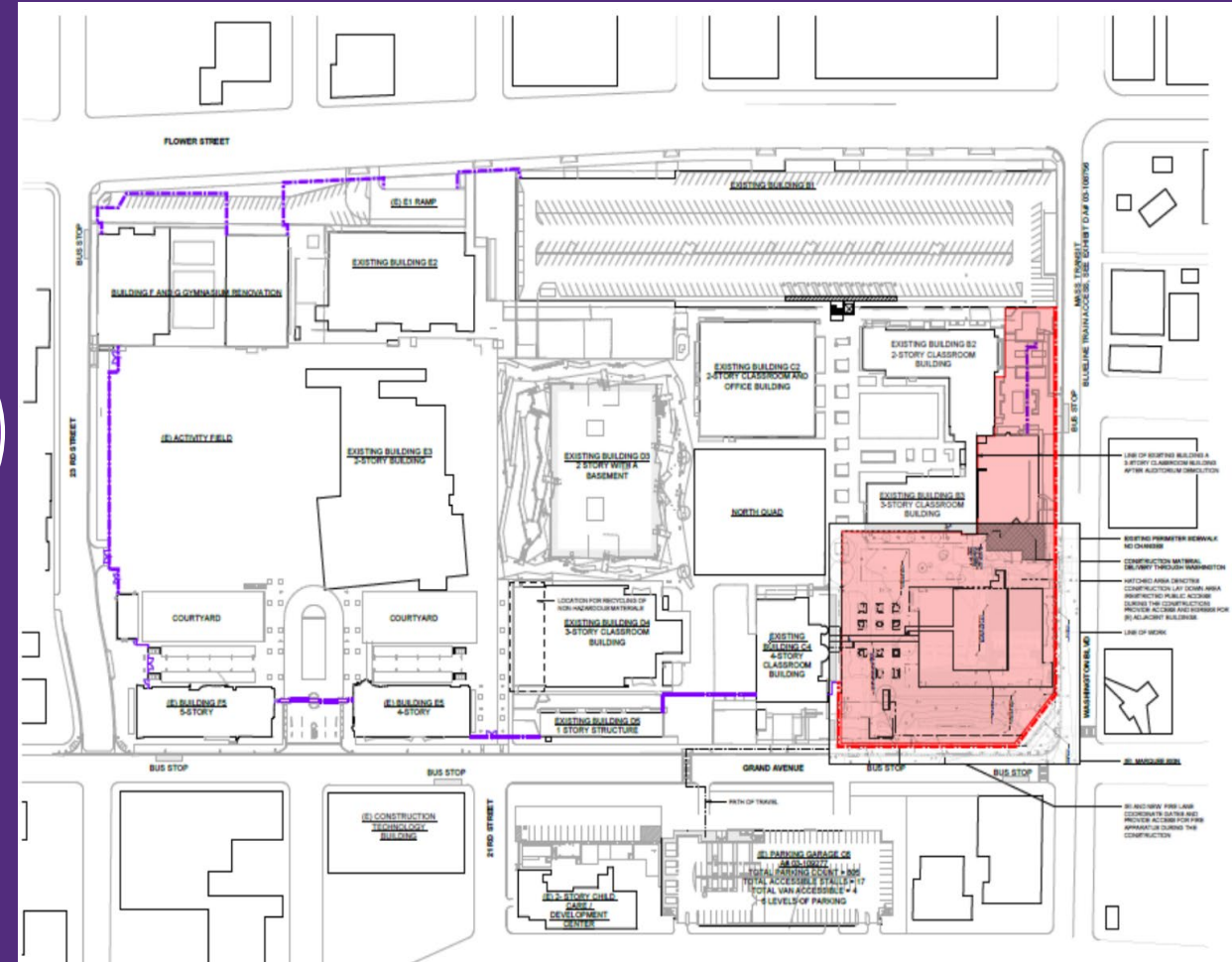
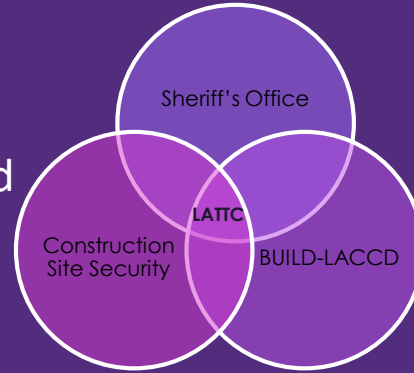



LATTC Elevators

On average, 80% of elevators are functional at any given time.
The goal is having 100% elevators functional.



Inventory:

- 19 passenger elevators
- 4 freight elevators
- 2 small freight elevators



Challenges:

- 7 different manufactures
- 25 elevators
- ADA Upgrades
- Duration of repairs made

Successes

- ✓ **2 Maintenance Contracts** have resulted in **over 100 issues** being resolved since January 2024
- ✓ **DSPS** Counselors and Staff support
- ✓ **Freight elevators** used as passenger alternative when possible
- ✓ Ordering **rebuilt parts** / identifying similar used relays from a different source
- ✓ Moving classes to a lower level when possible

A potential option includes **full modernization** (complete replacement) because an elevator is deemed unrepairable, but this is a lengthy process . The Division of the State Architect (DSA) would need to review and approve the project before proceeding with the procurement process and construction.



Communication & Transparency:

- WEC Monthly Agenda Item
- Monthly AFT Consultation
- Elevator Dashboard
- FMPOC
- All Campus Communication
- Signage

Academic Affairs Updates

- ▶ Dean of Academic Affairs Hiring Update
 - Academic & Workforce Connections, English, Language Arts & Humanities
Liberal Arts & Transfer Prep, Math
 - Closing out the Hiring Process
 - Winter Intersession/Early Spring 25 Start
- ▶ Winter 25 Enrollment
 - 209 Courses | Fill rate of 65% (23) | 51% of classes Full | @500 students on a waitlist
 - Modality Fill Rates | Online Courses: 70.15% | In-Person Courses: 57.81% | Hybrid Courses: 29.87%

Academic Affairs Updates

- ▶ Positive Attendance Reporting
 - Positive attendance
 - 2/3 of sections still outstanding
 - Loss of Funding
 - Resources | Video and PDF Screen Shot
 - Submit by December 15th | End of Term
- ▶ **Grades Submission Deadline | December 20th, 2024**

Mark Your Calendar

Spring Professional Development Day

- ▶ **Spring Professional Development Day** | 100 Years of Excellence at TRADE: Fostering Collaboration and Equity for Professional Growth
 - February 6, 2024
 - 9am-1pm | Zoom
 - Learning, Sharing and Growing Together
 - Diversity, Equity, Inclusion, Accessibility and Anti-Racism | AI | Knowledge Sharing
 - Submit topic ideas | pattonag@lattc.edu

Student Services Update

- ▶ Launch of Hire Up for Re-entry students
- ▶ Spring 2025 open house is scheduled for Friday, 01/24/2025 from 8:00 a.m. - 12:00 p.m.
- ▶ Super Saturday will be on 01/25/2025 from 9:00 a.m. - 1:00 p.m.



**Thank you for your dedication and
contributions to student success
throughout the semester!**