

## Student Parking Guidelines

You are responsible for knowing LATTC parking rules and regulations. This information is intended to provide students with basic guidelines on parking at the college. The complete text of the college's parking rules and regulations is printed in the College Catalog: [www.lattc.edu](http://www.lattc.edu). Student Parking Guidelines may be obtained from the LATTC Sheriff's Station, D4-150, the Business Office, E5-123, and the Administrative Services Office, E5-305.

- Student parking regulations are **enforced starting the first day of class each semester** through final examinations. A student parking decal is valid for the current academic term only and must be displayed at all times a vehicle is parked on college property. Saturday and Sunday parking rules and regulations are enforced in the same manner as weekdays.
- Parking decals are made of removable mylar and should be **affixed to the inside rear window, (lower right side, facing outward)**. **Vehicles with tinted rear windows may display the decal in the lower right or lower left front window. Any vehicle displaying a decal which is expired, altered, reported lost or stolen, or not completely visible is subject to a citation. Also, the failure to display a parking decal or parking in an area not authorized for student parking, including designated faculty/staff lots and levels, reserved spaces, or vehicles parked out of stall will result in the issuance of a citation. Illegally parked vehicles may be towed away at the owner's expense.**
- Regulations governing handicapped parking, red curbs, no-parking zones, fire lanes, special permit areas, and areas that have parking time limitations are enforced 24 hours a day, including weekends and holidays.
- A **valid college parking decal and a DMV placard must be displayed** on any vehicle parked in a designated handicapped stall.
- All traffic laws must be obeyed. The college speed limit is 7 miles per hour.
- The purchase of a student parking decal does not guarantee a parking space; it is only a permit to park one vehicle in the designated areas specified below (See Campus Map on reverse side):

**Preferred Student Parking (\$27.00 for Fall & Spring Semesters) (Includes a \$7.00 ASO Membership fee) – as available:**

- *Olive Street Parking Structure (C6)* – Entrance: Olive St., between Washington Bl. and 21st St.
- *Flower St. Lot (B1 Roof)* – Entrance: Southbound Flower St., between 22 St. and 23rd St.
- *24<sup>th</sup> St. Parking Structure (H6) 2<sup>nd</sup> through 5<sup>th</sup> Fl.* – Entrance: 24<sup>th</sup> St., between Grand Ave. and Hill St.

**General Student Parking (\$20.00 for Fall & Spring Semesters):**

- *24<sup>th</sup> St. Parking Structure (H6) 6<sup>th</sup> Fl. (top level)* – Entrance: 24<sup>th</sup> St., between Grand Ave. and Hill St.

**Preferred Student Parking (\$10.00 for Winter & Summer Sessions):**

- *Valid in all Preferred Student Parking Lots and the General Student Parking Lot.*

**PLEASE NOTE: After 3:00 p.m. a student with a general parking permit is allowed to park in any designated student parking lot, (preferred or general).**

- LATTC assumes no responsibility or liability for your car or its contents while parked in the lots. Also walking/wheelchair escort service only, is provided upon availability for students with physical or other limitations. Call the College Sheriff's Station at (213) 763-3600 and an officer will be dispatched to your location. **Note:** This is not a shuttle service.
- Inquiries regarding the college's parking program, parking rules and regulations, parking decal use and enforcement should be directed to the following offices during normal business hours: Business Office, (213) 763-7225, and the Administrative Services Office, (213) 763-7040. However, the LATTC Sheriff's Station personnel are on duty 24 hours a day, 7 days a week to assist with parking decal use and enforcement issues. Please call (213) 763-3600.
- **Decal Sales, Refunds, and Exchanges:** Please contact the Business Office, E5-123, (213) 763-7225. **Please note: There is "no free parking replacement" if a decal is lost or stolen.**
- **Parking Citation Appeals:** Individuals who believe a citation was issued to them in error must appeal it immediately by completing an Administrative Review form (available in the Sheriff's Station, D4-150) or the LATTC Sheriff's website under Parking Information). Appeals must be mailed to: Los Angeles Trade Technical College, c/o Parking Citation Service Center, P.O. Box 11923, Santa Ana, CA 92711. You may contact the LATTC Sheriff's Station for results within approximately three weeks. Failure to immediately pay or appeal a citation may result in substantial penalties and a Department of Motor Vehicle (DMV) hold on your vehicle registration.

**Note: This information is subject to change without notice.**

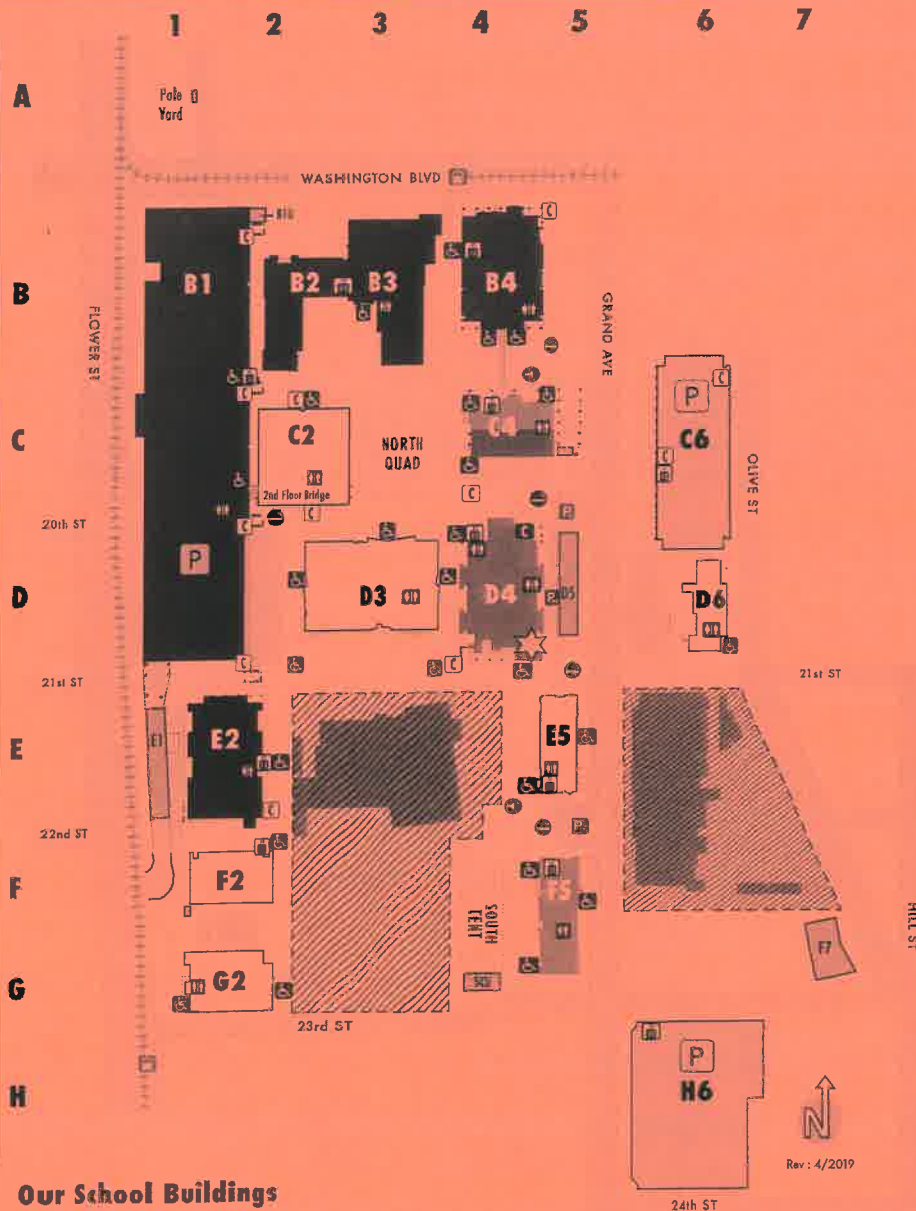

## Our Service Areas

Service	Bldg	Room
<b>GETTING STARTED &amp; ENROLLMENT</b>		
Admissions & Records	E5	1st Floor Lobby
Bridges to Success Center	D3	105
<b>ACADEMIC SERVICES</b>		
Academic Connections	D3	109
Distance Education	D3	07
Library	D3	2nd Floor
Open Computer Labs	D3	09
<b>COUNSELING &amp; HEALTH SERVICES</b>		
NextUP	E5	415
Cross Cultural Counseling Center	E5	214
Disabled Student Program & Services	D3	100
EOPS/Care	E5	416
GAIN/CalWorks	E5	403
International Students	E5	316
Student Health Center	D3	107
University Transfer Center	E5	203
Veteran Student Center	D3	101
<b>FINANCIAL &amp; RELATED SERVICES</b>		
Business Office	E5	1st Floor Lobby
College Store	C4	102
Financial Aid	E5	1st Floor Lobby
Financial Aid Lab	E5	314
<b>EMPLOYMENT &amp; INTERNSHIPS</b>		
Career Center	E5	413
Cooperative Work Experience Education (Internships)	C4	203A
Employment Center	C2	107A
Worksource Center	C2	106
<b>STUDENT LIFE</b>		
Associated Student Organization (ASO)	C2	105
Cafeteria	B4	
Gymnasium	G2	
Office of Student Life	C2	105
<b>COLLEGE SUPPORT &amp; ADMINISTRATIVE SERVICES</b>		
Academic Technology	D3	07
Administrative Services Office	E5	305
Copy/Mail Center	D3	06
Foundation	E5	513
Garden Room	B4	
Information Technology (IT)	D3	04
Innovation & Institutional Effectiveness	E5	519
Instructional Affairs Office	E5	512
Labor Center	D3	05
Office of the President	E5	543
Payroll/Personnel	E5	427
Physical Plant Office	D4	152
Recruitment	E5	513
Sheriff's Office	D4	150
Slate-Z	E5	543
Student Affairs Office	E5	532

## Our School Buildings

- B1** - School of Advanced **TRANSPORTATION & Manufacturing**  
(Formerly Oak Hall, Rooms F)
- B2** - School of **COSMETOLOGY**  
(Formerly Magnolia Hall, Rooms MH)
- B3** - School of **HEALTH & Related Sciences**  
(Formerly Magnolia Hall, Rooms MH)
- B4** - School of **CULINARY ARTS**  
(Formerly Sage Hall, Rooms H)
- C4** - School of **APPLIED SCIENCES**  
(Formerly Cedar Hall, Rooms K)
- C4** - School of **BUSINESS & Civic Engagement**  
(Formerly Cedar Hall, Rooms K)
- D4** - School of **DESIGN & MEDIA ARTS**  
(Formerly Cypress Hall, Rooms D)
- E2** - School of **CONSTRUCTION, Maintenance & Utilities**  
(Formerly Sequoia Hall, Rooms B)
- F5** - School of **LIBERAL ARTS**  
(Formerly Aspen Hall, Rooms TE)

## Our Services/Activities Buildings

- C2** - Tom Bradley Center for **Student Life**  
(Formerly Redwood Hall, Rooms C)
- D3** - **Student Support Center (The Hub)**  
(Formerly Maniposa Hall, Rooms MA)
- D6** - Child Development Center (**CDC**)
- E5** - **Administration/Services Building**  
(Formerly Juniper Hall, Rooms ST)
- F2** - **Athletics Building**  
(Formerly Willow Hall, Rooms J)
- G2** - **Gymnasium**  
(Formerly Laurel Gym, Rooms G)

LEGEND		
Sheriff's Office	Public Pay Phone	Accessible Drop-Off
Construction Area	Emergency Blue Phone	Student Parking (unless otherwise noted)
Smoking Area	Elevator	Motorcycle Parking
Free-Speech Area	Accessible Entrance	Sheriff Parking
Metro Rail Stop	Gender Neutral Restroom	

Gender Neutral Restrooms			Location Rooms
B1-108E	D5-131	D6-210	C4-213
B3-318	D5-320	E2-231	
B4-135	D6-106	E2-338	
C2-104A	D6-116	E5-108	
C4-215	D6-117	F5-211	
D3-107G	D6-209	G2-101	

UTILITY/RESOURCE BUILDINGS & PARKING	
C6 - Olive St. Parking	FT - LADWP
H6 - 24th St. Parking	B1U - B1 Utility
D5 - M&O Resource	SCU - South Campus Utility
E1 - Central Receiving	